

This survey was prepared at the request of the City of Humphrey, Nebraska.

LEGAL DESCRIPTION

Area 2019-1
 A tract of land located in the Southwest 1/4 and the Northwest 1/4 of the Southeast 1/4 and the Southwest 1/4 of the Northeast 1/4 of Section 19, T20N, R1W of the 6th P.M., Platte County, Nebraska, more particularly described as follows:

Commencing at the West 1/4 corner of Section 19, T20N, R1W of the 6th P.M., Platte County, Nebraska; thence N 87°54'27" E on the North line of the Southwest 1/4 of said Section 19, 493.17 feet to a point on the East Right-of-Way line of Union Pacific Railroad Company; thence S 11°41'43" E on said East Right-of-Way line, 279.69 feet to a point on the North Right-of-Way line of Nebraska State Highway Spur, said point being the Point of Beginning; thence S 11°41'43" E on said East Right-of-Way line, 430.15 feet; thence S 78°18'26" W on said East Right-of-Way line, 49.79 feet to a point of curvature; thence Southwesterly on a 1532.90 foot radius curve to the right on said East Right-of-Way line, 616.26 feet of which said curve has a chord bearing of S 00°34'05" E, 612.12 feet to a point on the South line of the Northwest 1/4 of said Southwest 1/4; thence N 87°56'38" E on said South line, 731.50 feet to the Northwest Corner of the Southeast 1/4 of said Southwest 1/4; thence S 00°50'52" W on the West line of the Southeast 1/4 of said Southwest 1/4, 524.09 feet; thence N 60°51'16" E on the Centerline of the Former Chicago & Northwestern Railroad Co., 3015.36 feet to a point on the East line of the Northwest 1/4 of the Southeast 1/4; thence N 01°51'01" W on said East line, 471.34 feet to the Northeast Corner of the Northwest 1/4 of said Southwest 1/4; thence N 01°25'46" W on the East line of the Southwest 1/4 of the Northeast 1/4 of said Section 19, 450.52 feet to a point on the North Right-of-Way line of Nebraska State Highway Spur; thence S 87°59'52" W on said North Right-of-Way line, 260.07 feet to a point of curvature on said North Right-of-Way line; thence Southwesterly on a 2888.28 foot radius curve to the left, 610.74 feet of which said curve has a chord bearing of S 81°56'39" W, 609.70 feet to a point of curvature on said North Right-of-Way line; thence Southwesterly on a 2904.79 foot radius curve, 481.08 feet of which said curve has a chord bearing of S 72°17'28" W, 480.53 feet; thence S 71°37'03" W on said North Right-of-Way line, 847.55 feet to a point of curvature on said North Right-of-Way line; thence Southwesterly on a 2822.94 foot radius curve to the right, 847.55 feet of which said curve has a chord bearing of S 76°47'54" W, 844.37 feet; thence S 88°21'27" W on said North Right-of-Way line, 465.68 feet; thence N 02°57'05" W on said North Right-of-Way line 15.78 feet; thence S 87°54'05" W on said North Right-of-Way line, 706.54 feet to the Point of Beginning;

EXCEPT

A tract of land located in the Northeast 1/4 of the Southwest 1/4 of Section 19, T20N, R1W of the 6th P.M., Platte County, Nebraska, more particularly described as follows:

Beginning at the Northwest corner of Bender Subdivision, Platte County, Nebraska; thence N 89°09'19" E on the South Right-of-Way line of Nebraska State Highway Spur, 72.51 feet to a point of curvature on said South Right-of-Way line; thence Northeastly on a 3866.15 foot radius curve to the left on said South Right-of-Way line, 112.38 feet of which said curve has a chord bearing of N 88°06'02" E, 112.37 feet to a point on the East line of said Bender Subdivision; thence S 04°28'29" E on said East line, 645.94 feet; thence N 79°47'41" E, 115.88 feet; thence S 04°33'42" E, 249.69 feet; thence S 79°47'38" W, 301.85 feet to the Southwest corner of said Bender Subdivision; thence N 04°28'13" W on the West line of said Bender Subdivision, 924.11 feet to the Point of Beginning, containing 4.52 acres more or less.

AND EXCEPT

A tract of land located in the Northeast 1/4 of the Southwest 1/4 and the Northwest 1/4 of the Southeast 1/4 of Section 19, T20N, R1W of the 6th P.M., Platte County, Nebraska, more particularly described as follows:

Beginning at the Northeast corner of Bender Subdivision, Platte County, Nebraska; thence S 04°28'29" E on the East line of said Bender Subdivision, 100.00 feet; thence N 86°20'54" E, 133.01 feet; thence N 84°28'32" E, 133.07 feet; thence N 82°18'47" E, 132.92 feet; thence N 79°39'04" E, 133.18 feet; thence N 77°11'43" E, 132.91 feet; thence N 74°39'52" E, 132.99 feet; thence N 72°06'06" E, 133.06 feet; thence N 70°09'27" E, 266.02 feet; thence N 18°46'22" W, 100.00 feet to a point on the South Right-of-Way line of Nebraska State Highway Spur; thence S 71°13'13" W on said South Right-of-Way line, 227.56 feet to a point on the East line of the Northeast 1/4 of the Southwest 1/4 of Section 19, T20N, R1W of the 6th P.M., Platte County, Nebraska; thence S 01°01'15" E on said East line, 5.22 feet; thence S 71°14'11" W on said South Right-of-Way line, 53.00 feet to a point of curvature on said South Right-of-Way line; thence Southwesterly on a 2907.94 foot radius curve to the right, 614.36 feet of which said curve has a chord bearing of S 77°11'30" W, 613.22 feet to a point of curvature on said South Right-of-Way line; thence Southwesterly on a 3866.15 foot radius curve to the right, 275.72 feet of which said curve has a chord bearing of S 85°21'18" W, 275.66 feet to the Point of Beginning, containing 2.72 acres more or less.

Tract of land as described above contains 72.09 acres more or less.

Area 2019-2

A tract of land located in the Northeast 1/4 of the Southwest 1/4 of Section 19, T20N, R1W of the 6th P.M., Platte County, Nebraska, more particularly described as follows:

Beginning at the Northwest corner of Bender Subdivision, Platte County, Nebraska; thence N 89°09'19" E on the South Right-of-Way line of Nebraska State Highway Spur, 72.51 feet to a point of curvature on said South Right-of-Way line; thence Northeastly on a 3866.15 foot radius curve to the left on said South Right-of-Way line, 112.38 feet of which said curve has a chord bearing of N 88°06'02" E, 112.37 feet to a point on the East line of said Bender Subdivision; thence S 04°28'29" E on said East line, 645.94 feet; thence N 79°47'41" E, 115.88 feet; thence S 04°33'42" E, 249.69 feet; thence S 79°47'38" W, 301.85 feet to the Southwest corner of said Bender Subdivision; thence N 04°28'13" W on the West line of said Bender Subdivision, 924.11 feet to the Point of Beginning, containing 4.52 acres more or less.

Area 2019-3

A tract of land located in the Northeast 1/4 of the Southwest 1/4 and the Northwest 1/4 of the Southeast 1/4 of Section 19, T20N, R1W of the 6th P.M., Platte County, Nebraska, more particularly described as follows:

Beginning at the Northeast corner of Bender Subdivision, Platte County, Nebraska; thence S 04°28'29" E on the East line of said Bender Subdivision, 100.00 feet; thence N 86°20'54" E, 133.01 feet; thence N 84°28'32" E, 133.07 feet; thence N 82°18'47" E, 132.92 feet; thence N 79°39'04" E, 133.18 feet; thence N 77°11'43" E, 132.91 feet; thence N 74°39'52" E, 132.99 feet; thence N 72°06'06" E, 133.06 feet; thence N 70°09'27" E, 266.02 feet; thence N 18°46'22" W, 100.00 feet to a point on the South Right-of-Way line of Nebraska State Highway Spur; thence S 71°13'13" W on said South Right-of-Way line, 227.56 feet to a point on the East line of the Northeast 1/4 of the Southwest 1/4 of Section 19, T20N, R1W of the 6th P.M., Platte County, Nebraska; thence S 01°01'15" E on said East line, 5.22 feet; thence S 71°14'11" W on said South Right-of-Way line, 53.00 feet to a point of curvature on said South Right-of-Way line; thence Southwesterly on a 2907.94 foot radius curve to the right, 614.36 feet of which said curve has a chord bearing of S 77°11'30" W, 613.22 feet to a point of curvature on said South Right-of-Way line; thence Southwesterly on a 3866.15 foot radius curve to the right, 275.72 feet of which said curve has a chord bearing of S 85°21'18" W, 275.66 feet to the Point of Beginning, containing 2.72 acres more or less.

Area 2019-4

A tract of land located in the Northeast 1/4 and the Northwest 1/4 of the Southwest 1/4 of Section 19, T20N, R1W of the 6th P.M., Platte County, Nebraska, more particularly described as follows:

Beginning at the Center of Section 19, T20N, R1W of the 6th P.M., Platte County, Nebraska; thence S 01°01'15" E on the East line of the Northeast 1/4 of the Southwest 1/4 of said Section 19, 153.53 feet to a point on the North Right-of-Way line of Nebraska State Highway Spur; thence S 71°37'03" W on said North Right-of-Way line, 80.32 feet to a point of curvature on said North Right-of-Way line; thence Southwesterly on a 2822.94 foot radius curve to the right, 847.55 feet of which said curve has a chord bearing of S 76°47'54" W, 844.37 feet; thence S 88°21'27" W on said North Right-of-Way line, 465.68 feet; thence N 02°57'05" W, 291.32 feet to a point on the North line of said Southwest 1/4; thence N 87°54'27" E on said North line, 1385.92 feet to the Point of Beginning, containing 8.38 acres more or less.

Area 2019-5

A tract of land located in the Northwest 1/4 of the Southeast 1/4 and the Southwest 1/4 of the Northeast 1/4 of Section 19, T20N, R1W of the 6th P.M., Platte County, Nebraska, more particularly described as follows:

Beginning at the Center of Section 19, T20N, R1W of the 6th P.M., Platte County, Nebraska; thence N 01°03'07" W on the West line of the Southwest 1/4 of the Northeast 1/4 of said Section 19, 372.28 feet; thence N 89°00'18" E, 458.57 feet; thence S 01°18'18" E, 387.62 feet to a point of curvature on the North Right-of-Way line of Nebraska State Highway Spur; thence Southwesterly on a 2904.79 foot radius curve to the left, 481.08 feet of which said curve has a chord bearing of S 72°17'28" W, 480.53 feet to a point on the West line of the Northwest 1/4 of the Southeast 1/4 of said Section 19; thence N 01°01'15" W on said West line, 153.53 feet to the Point of Beginning, containing 4.75 acres more or less.

SURVEYOR'S CERTIFICATE

I, Terry L. Schulz, a Registered Land Surveyor of the State of Nebraska, do hereby certify that the survey described above was made by me or under my direct supervision on October 14, 2020; also that all dimensions are in feet and are correct to the best of my knowledge and belief.

Terry L. Schulz, State of Nebraska, R.L.S. #550 Date _____

FIELD NOTES

- A) West 1/4 Corner, Section 19, T20N, R1W: Found 3/4" Iron Bar. 39.11' NE to Center of Fire Hydrant. 42.73' SE to Center of Manhole.
- B) Center of Section 19, T20N, R1W: Found 1" Iron Pipe with Nail as recorded by Thomas A. Tremel, LS#455, dated October 2, 2014. 46.63' ENE to Southwest Corner of House. 101.40' NE to Northwest Corner of House. 100.00' North to 1"x24" Metal Tubing with Plastic Cap.
- C) East 1/4 Corner, Section 19, T20N, R1W: Found 2" Aluminum Cap as recorded by Thomas A. Tremel, LS#455, dated October 2, 2014. 58.92' SE to Survey Mark. 82.42' NE to Survey Mark. 17.50' NW to Railroad Spike in Island. 25.2' East to Centerline of U.S. Highway #81. 6.1' North to Centerline of Highway Spur West.
- D) Southwest Corner, Section 19, T20N, R1W: Found Survey Spike with Washer, LS#455 as Recorded by Thomas A. Tremel. 53.21' NW to Nail & Disc in Power Pole. 51.21' NE to Nail & Disc in Power Pole.
- E) Northeast Corner, Northwest 1/4, Southeast 1/4, Section 19, T20N, R1W: Found Survey Spike with Washer, LS#455. 42.90' NNW to Southeast Corner of Concrete Channel. 42.31' North to South Face of Steel Post. 77.19' NE to "X" Nails in Power Pole. 39.42' South to 1" Iron Pipe, LS#455. 1.93' North to Centerline of State Highway Spur.

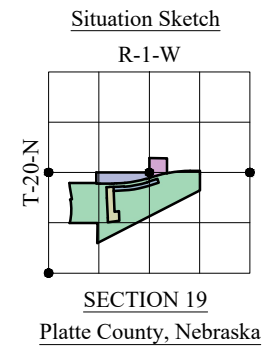

LEGEND

- Section Corner Found
- Property Corner Found
- Calculated Point
- Measured Distance
- Recorded Distance
- Calculated Distance

Drawn By: LRR
Date: October 8, 2020
Project Number: S-071-109
Scale: 1" = 200'

SCALE IN FEET

0 100 200 400

